

BI-DIRECTIONAL KNIFE GATE VALVE

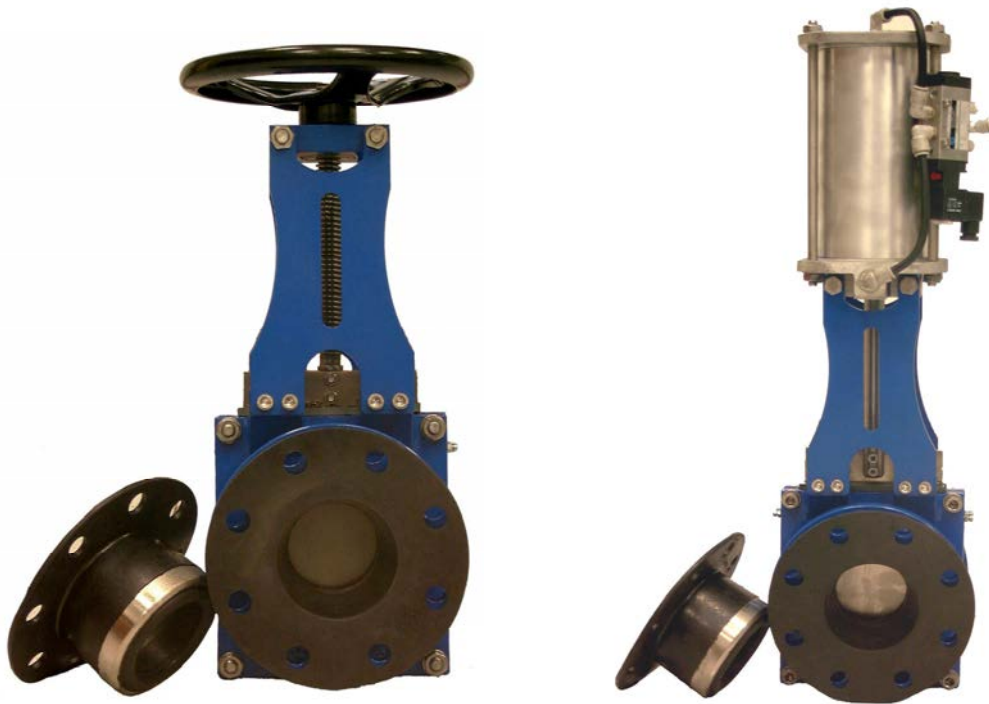

The SL-CYL model knife gate is a Bi-directional valve, equipped with automatic or manual driver, that by its double seated design ensures a bubble-tight shut off in both directions of the flow, making it suitable for abrasive mediums.

GENERAL FEATURES

- Bi-directional shut off
- Two split body arrangements
- Two heavy duty rubber sleeves
- Fully lugged body style
- Packingless design
- Elastomeric sleeves can easily be replaced, without disassembling the valve.
- Full bore reduces pressure drop and cavities, minimizing wear
- Easy drive replacement
- Self cleaning design
- Proximity and limit switch mounting points as standard

APPLICATION FIELDS

- Mining and mineral processing
- Mine Dewatering
- Cement industry
- Pipeline transport
- General industry
- Etc.

TECHNICAL DATA

Size range: DN-50 (2") to DN-600 (24")







Flange ratings: PN-10 / ASA 150
(Other flange drillings under customer's request)

Pressure class: variable according to size
(refer to dimensions table)

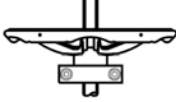
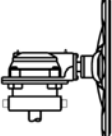
Temperature range: variable according to the sealing material.

Coating: internally and externally fusion bonded epoxy coated. RAL 5017, 80-150 microns, as standard
(Other RAL and thicknesses under request)

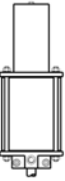
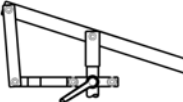
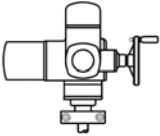
ASSEMBLY CONFIGURATION

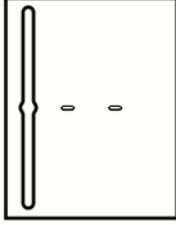
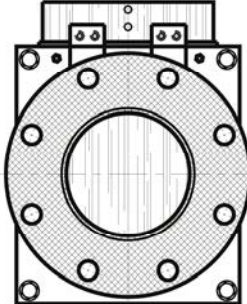
	STANDARD	OPTIONAL			
OPERATION	 Rising stem handwheel  Gearbox	 Rising stem coupling A  Oil hydraulic actuator	 Double acting pneumatic actuator  Chain Wheel	 Spring-return pneumatic actuator  Quick closing lever	 Electric actuator
SHROUD (PLATES)	 Open shroud	 Hand protections for automated valves			
BODY	 Fully lugged				
ACCESORIES	<ul style="list-style-type: none"> - Revolving handle - Locking device - Overriding actuator - Mechanical limit switches - Proximity limit switches - Solenoid valve - Extended guided plates - Scraper - Etc. 				

MATERIAL SPECIFICATION & PART LIST

No.	DESCRIPTION	MATERIAL
1	Gate	SS 316 (standard) DUPLIX 2205, SMO 254, SS 316TI, SS 316L (optional)
2	Body	GJL250 Iron
3	Tight seat	NATURAL RUBBER
4	Guides	1.0580
5	Grease nipple	COMMERCIAL
6	Screw and nut	A-4
7	Packing guides	PLASTIC
8	Open shroud	1.0580
-	Stem	SS 316
-	Bearing	1.0401 (standard) SS 316 (optional)
-	Handwheel	1.0037
-	Pneumatic act.	Aluminium
-	Hand-protections	1.0580

Figure 1. Exploded view of KGV-SL fully lugged with open shroud

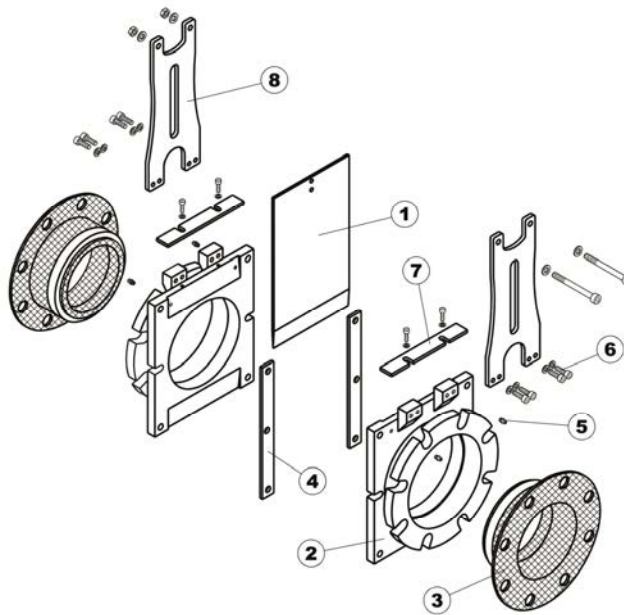

APPLICATION AND TEMPERATURE RANGE OF SEALING MATERIALS

RESILIENT SEATS			
Material	Min. temperature (°C)	Max. temperature (°C)	APPLICATIONS
NATURAL RUBBER	-10	+70	Tear and abrasion resistant

*More details and other sealing materials under request.

DIMENSIONAL DRAWINGS

Figure 2. KGV-SL fully lugged rising stem & handwheel

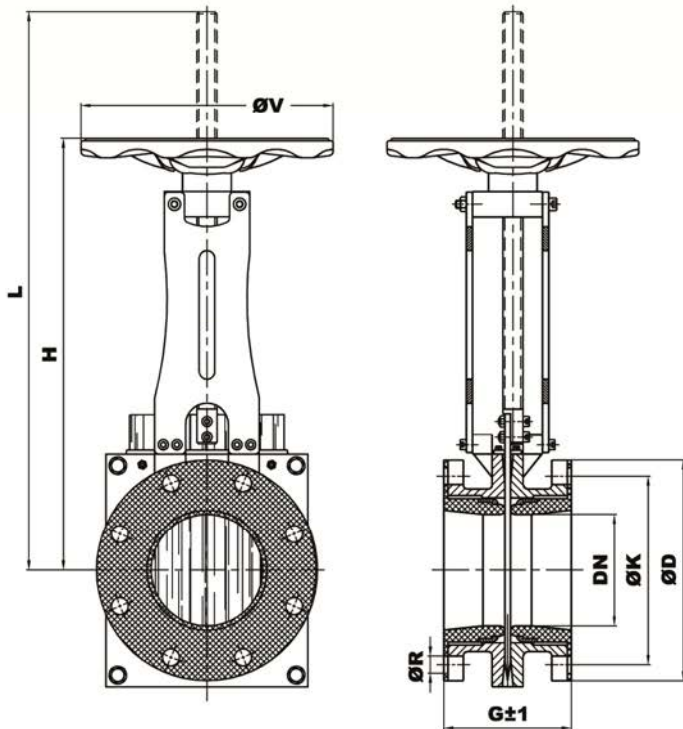

Figure 3. KGV-SL fully lugged rising stem with handwheel & gearbox

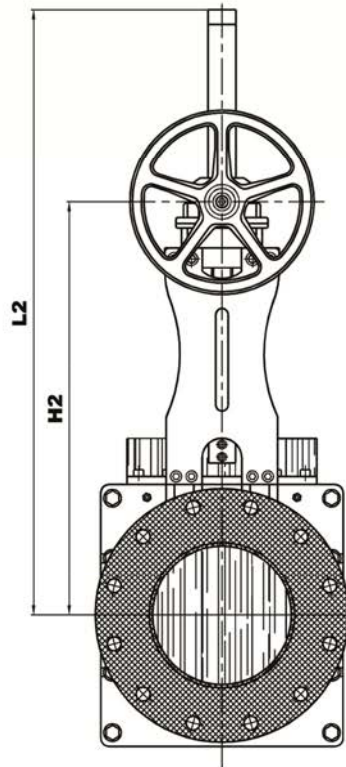
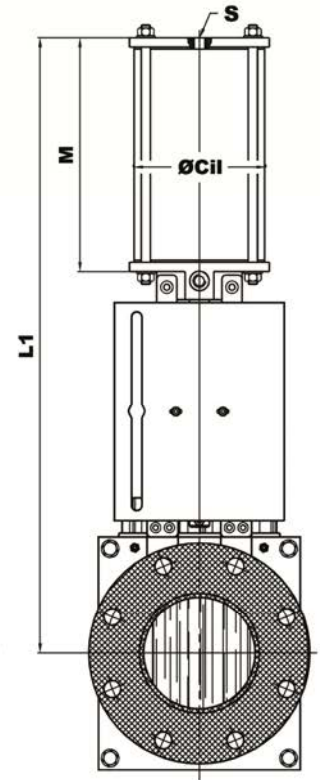

Figure 4. KGV-SL fully lugged with d/a pneumatic actuator



DN	G±1	H	L	ØV	L2	H2	L1	M	ØCil	S	Spindle thread	Max. Working Pressure (bar)
50	129	311	415	225	-	-	442	184	100	1/4 " G	Tr20x4i	10
65	131	344	474	225	-	-	500	209	100	1/4 " G	Tr20x4i	10
80	144	371	513	225	-	-	545	227	100	1/4 " G	Tr20x4i	10
100	151	402	552	225	-	-	602	253	125	3/8 " G	Tr20x4i	10
125	162	487	688	300	-	-	719	290	160	3/8 " G	Tr24x5i	10
150	164	533	754	300	-	-	818	326	160	3/8 " G	Tr24x5i	8
200	169	626	893	400	-	-	936	375	190	1/2 " G	Tr28x5i	5
250	211	721	1032	400	-	-	1114	462	250	1/2 " G	Tr28x5i	5
300	234	809	1182	400	-	-	1278	524	250	1/2 " G	Tr28x5i	5
350	242	946	1449	500	1449	946	1445	576	300	1/2 " G	Tr40x7i	4
400	257	1957	1650	500	1650	1957	1609	697	350	1/2 " G	Tr40x7i	4
450	260	1148	1751	500	1751	1148	1833	787	400	1/2 " G	Tr50x8i	4
500	263	1191	1844	500	1844	1191	1881	837	400	1/2 " G	Tr50x8i	3
600	285	1348	2101	500	2101	1348	2205	937	400	1/2 " G	Tr50x8i	3

* We advise gearbox for valves above DN-350.

* Data sheet for ØK & ØD stated in "flange drillings chapter".

FLANGE DRILLINGS

FLANGE DRILLING- PN10

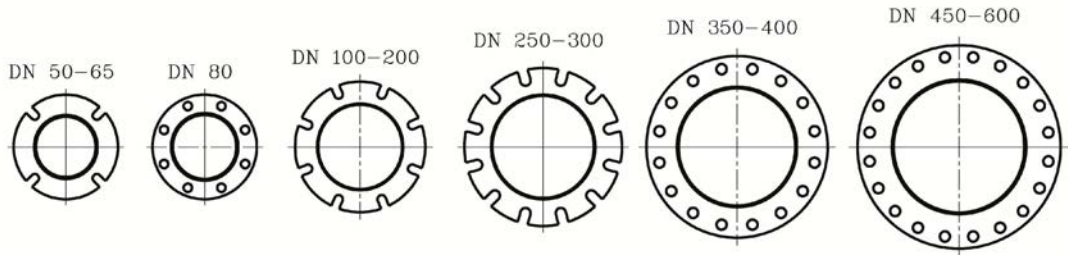

Bolting Arrangements PN-10 Knife Gate Valve

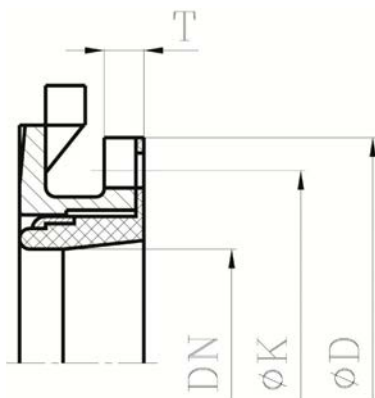

DN	K	D	N	T	R
50	125	160	4	16	M-16
65	145	180	4	19	M-16
80	160	190	8	22	M-16
100	180	220	8	22	M-16
125	210	250	8	27	M-16
150	240	280	8	27	M-20
200	295	336	8	27	M-20
250	350	395	12	27	M-20
300	400	480	12	40	M-20
350	460	530	16	40	M-20
400	515	605	16	47	M-24
450	565	640	20	50	M-24
500	620	698	20	50	M-24
600	725	820	20	50	M-27

FLANGE DRILLING- ASA 150

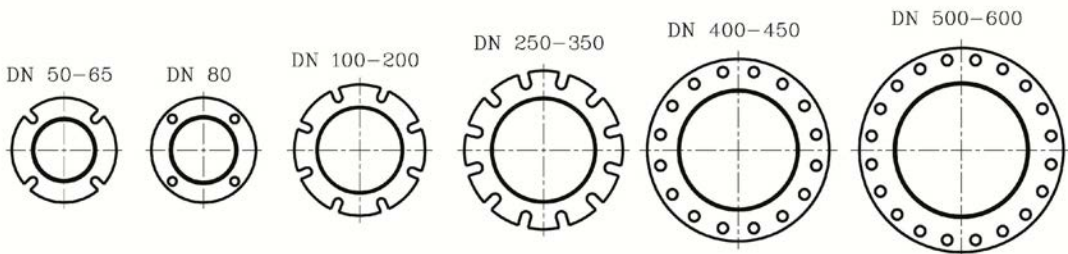

Bolting Arrangements ASA 150 Knife Gate Valve

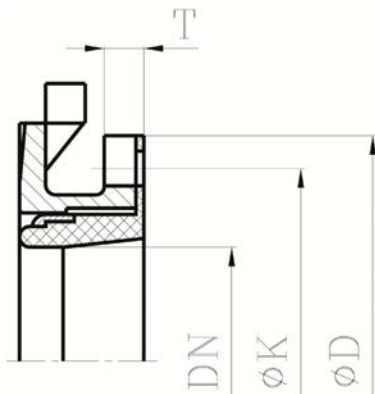

DN	K	D	N	T	R
50	120,60	160	4	16	5/8 "
65	139,70	180	4	19	5/8 "
80	152,40	190	4	22	5/8 "
100	190,50	220	8	22	5/8 "
125	215,90	250	8	27	3/4 "
150	241,30	280	8	27	3/4 "
200	298,40	336	8	27	3/4 "
250	361,90	395	12	27	7/8 "
300	431,80	480	12	40	7/8 "
350	476,20	530	12	40	1 "
400	539,70	605	16	47	1 "
450	577,80	640	16	50	1 1/8 "
500	635,00	698	20	50	1 1/8 "
600	749,30	820	20	55	1 1/4 "

ORDERING GUIDE

SERIES	OPERATIONS	MATERIAL	DN	SEAT	BODY TYPE	FLANGE
Example: SL	V	11		NR	LW	PN-10
SL	V → Handwheel r.s	11 → Cast iron		NR → NATURAL RUBBER	LW → Fully Lugged (BETWEEN FLANGES)	PN-10
	VR → Handwheel r.s + Bevel Gearbox					ASA 150
	B → Iso top flange r.s.					AS-2129 Table C/D
	BR → Iso top flange r.s. + Bevel Gearbox					
	M → Electric actuator r.s.					
	MR → Electric actuator r.s. + Bevel Gearbox					
	P → Quick closing lever					
	N → D/A penumatic actuator					
	SE → S/A penumatic actuator					
	H → Oil hydraulic actuator					
	VCH → Chain wheel r.s.					
	VCHR → Chain wheel r.s. + Bevel Gearbox					